



CUPRA LEON e-HYBRID Sportstourer

5 doors / 5 seats / stationwagon

From 2024



CUPRA

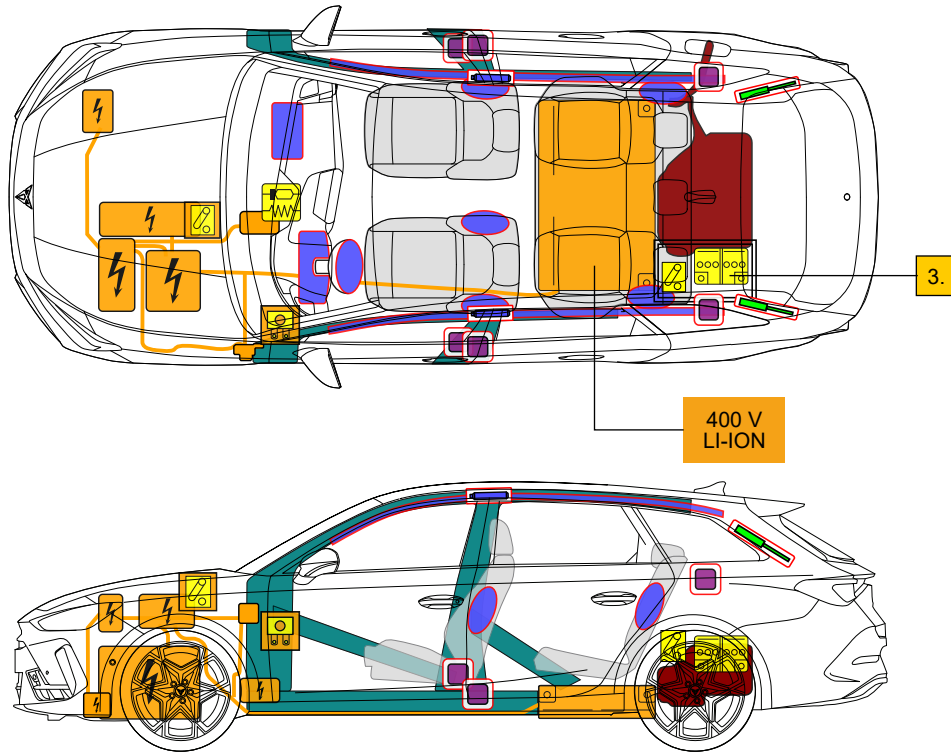

Note: The illustration shows the maximum possible equipment.

	Airbag		Stored gas inflator		Seat belt pretensioner		SRS control unit		Fuel tank content gasoline
	Gas strut / Preloaded spring		High strength zone		Battery low voltage		Low voltage device that disconnects high voltage		Fuse box disabling high voltage
	Battery pack, high-voltage		High voltage power cable		High voltage component		Zone requiring special attention		Device to shut down power in vehicle

Brand	Modele	Year of Launch	Internal reference	Creation date	Update date	Version	Page
CUPRA	LEON	2024	VSS-KUD1H50	26/04/2024	11/06/2025	2	1 / 4



CUPRA LEON e-HYBRID Sportstourer

5 doors / 5 seats / stationwagon

From 2024



CUPRA

1. Identification / recognition



The electric motor does not emit noise. The powermeter on the instrument panel indicates whether the electric motor is disconnected ("OFF") or connected and ready for operation ("READY").

Logo



Charging port



Engine compartment

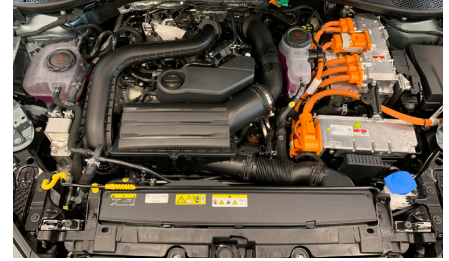

2. Immobilisation / stabilisation / lifting

Immobilise the vehicle

1. Engage the electric parking brake (see steps a and b).
2. Switch off the ignition (see chapter 3).
3. Secure the vehicle to prevent it from moving.

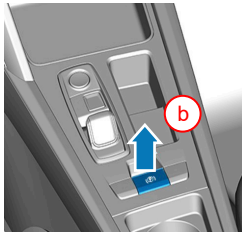
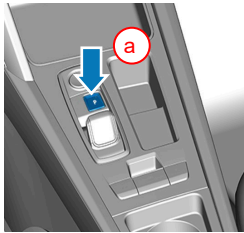

Suitable lifting points

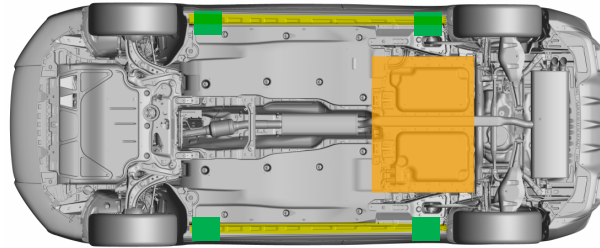

 Suitable lifting points

 Battery pack, high-voltage

3. Disable direct hazards / safety regulations

Switch off ignition

Multifunction steering wheel:

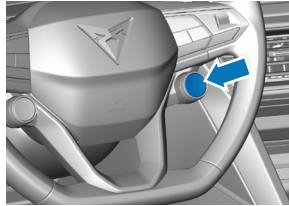

Center console:



Press the START - ENGINE - STOP button, located (depending on model) on the multifunction steering wheel or on the center console, without pressing the brake pedal.

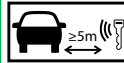

Keep the vehicle key and/or smartphone app further than 5 m away from the vehicle.

High-voltage system deactivation

In case of accidents with airbag deployment, the high-voltage system is automatically and immediately deactivated upon detecting the airbag deployment. The high-voltage is de-energized approximately 20 seconds after deactivation



Do not touch, cut, or open damaged high-voltage components, cables, or batteries!
Wear appropriate protective equipment!

Brand	Modele	Year of Launch	Internal reference	Creation date	Update date	Version	Page
CUPRA	LEON	2024	VSS-KUD1H50	26/04/2024	11/06/2025	2	2 / 4



Option 1: from the engine compartment

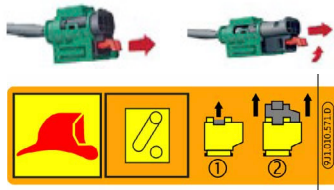

Option 2: from passenger compartment

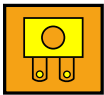

Left-hand drive vehicle:

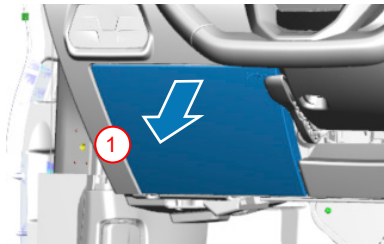

1. Release the cover next to the steering column with a screwdriver.
2. Pull the tag to disconnect the fuse.

Right-hand drive vehicle:

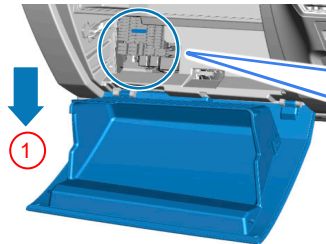

1. To set the glove box to the service position, release the side retaining tabs.
2. Pull the tag to disconnect the fuse.



Disconnecting the 12-volt battery

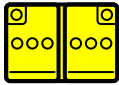

1. Locate the battery cover located on the left side of the trunk.
2. Disconnect the negative cable from the chassis to deactivate the 12V onboard network.
3. Insulate the disconnected cable to avoid contact with the chassis.

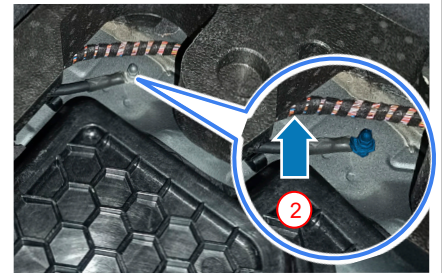

Disconnecting the charging station (emergency unlock)



1. Locate and pull the yellow ring located on the left side of the engine compartment.
2. Disconnect the charger.

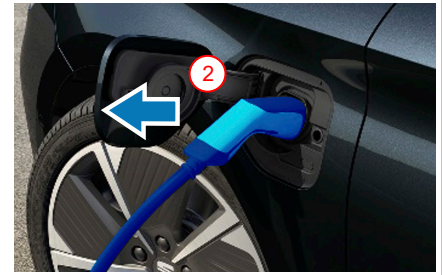

4. Access to the occupants

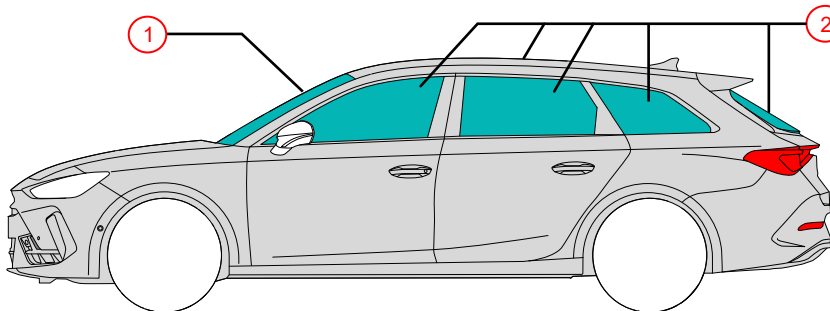

Glass types:

- ① Laminated safety glass
- ② Tempered glass

Brand	Modele	Year of Launch	Internal reference	Creation date	Update date	Version	Page
CUPRA	LEON	2024	VSS-KUD1H50	26/04/2024	11/06/2025	2	3 / 4



CUPRA LEON e-HYBRID Sportstourer

5 doors / 5 seats / stationwagon
From 2024



CUPRA

5. Stored energy / liquids / gases / solids

							Max. 40 L
							12 V
							400 V Lithium-Ion

If the battery system is mechanically deformed, there is a risk of a thermal reaction in the high-voltage battery.
Monitor the temperature of the high-voltage battery!

6. In case of fire

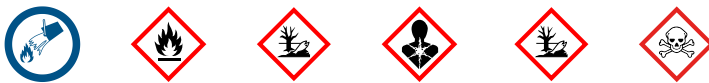

Lithium-ion batteries can self-ignite or reignite after extinguishing the fire!
Wear appropriate protective equipment!

7. In case of submersion

After rescuing the vehicle from the water, deactivate the high-voltage system (see Chapter 3) and allow the water to drain. Wear appropriate protective equipment!

8. Towing / transportation / storage

Lithium-ion batteries can self-ignite or reignite after extinguishing the fire!
Wear appropriate protective equipment!

If the vehicle has been involved in an accident or if the HV battery is damaged or unstable: Deactivate the high-voltage system (see Section 3). Park the vehicle at a safe distance, at least 5 m, from buildings and other vehicles (quarantine area).

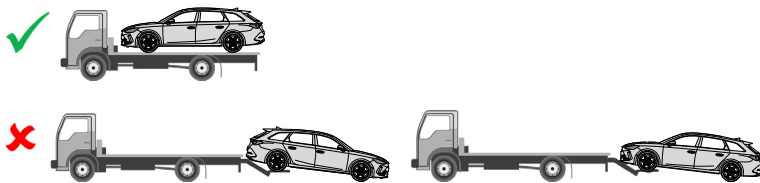

Do not tow a vehicle that has been involved in an accident on its drive axles.

9. Important additional information

Rescue manual for CUPRA: <https://www.cupraofficial.com>

10. Explanation of pictograms used

Flammable	Corrosives	Hazardous to the human health	Environmental hazard	Acute toxicity	Use water to extinguish the fire	Warning, Electricity	General warning sign
Use thermal Infrared camera	Remove smart key	Bonnet	Boot	Hybrid Electric Vehicle on fuel of liquid group 2			

Brand	Modele	Year of Launch	Internal reference	Creation date	Update date	Version	Page
CUPRA	LEON	2024	VSS-KUD1H50	26/04/2024	11/06/2025	2	4 / 4